

Clipper

SLEEK SERIES
SYSTEM FOR GLASS PARTITION

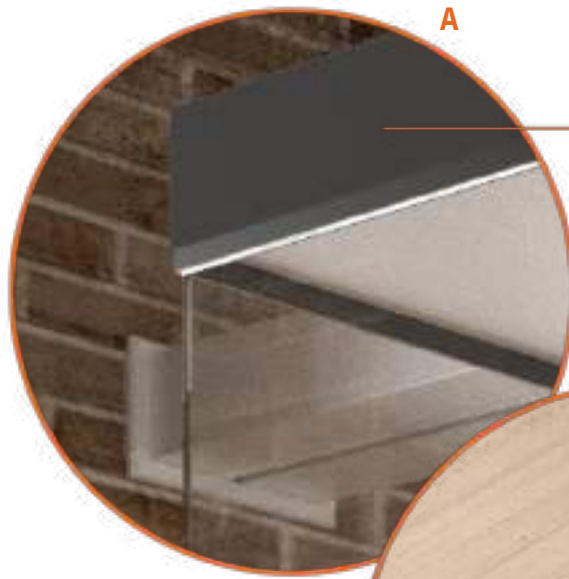



A

SLEEK1630

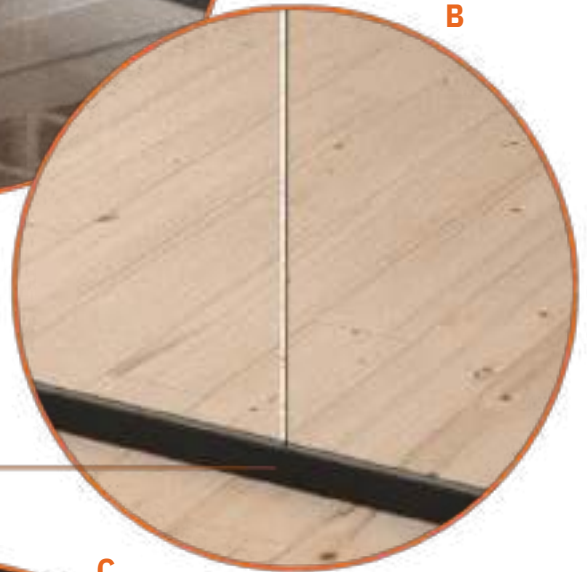

B

SLEEK2130

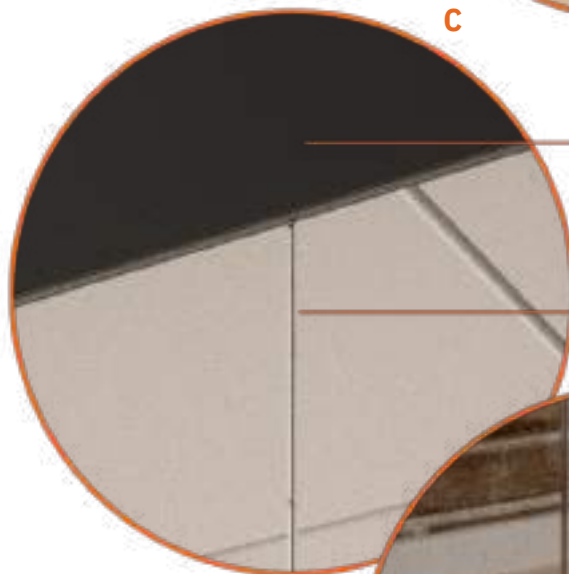

C

SLEEK1630

PH2784

PH2792

SLEEK2130



D





PROFILE FOR GLASS DOORS FIXED ON GLASS WALLS FOR THICKNESS FROM 8 TO 13.52 mm

Material: extruded aluminium

Features: suitable for all glasses compatible with SLEEK profiles.

Wall glass thickness from 8 to 13.52 mm.

It can be matched with all the hinges of our production.

Matching with CER4AL, CER4ALSQ hinges

and APRO 1203, APRO 2203,

APRO CENTRALE AND APRO PER STIPITE locks

Finish: aluminium, anodized, black matt,
other finishes on demand

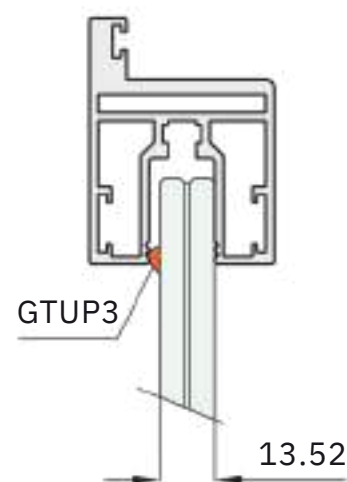
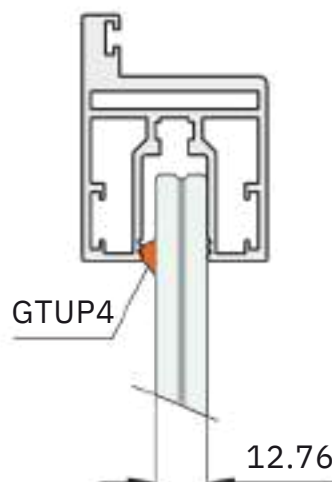
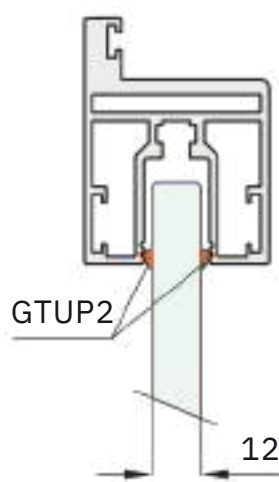
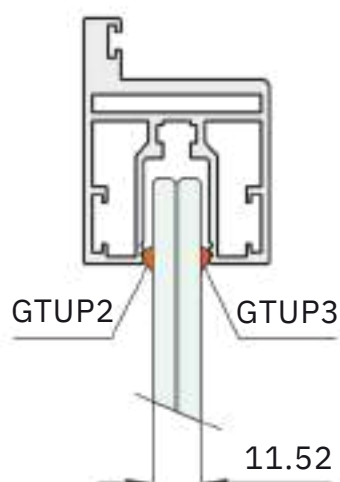
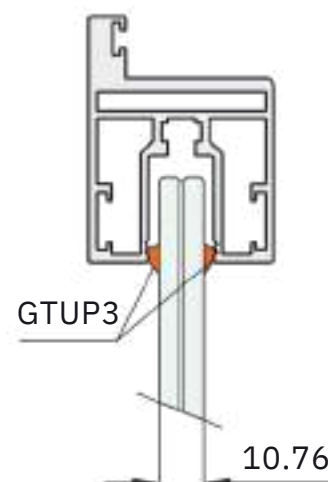
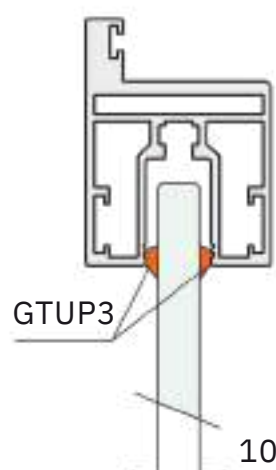
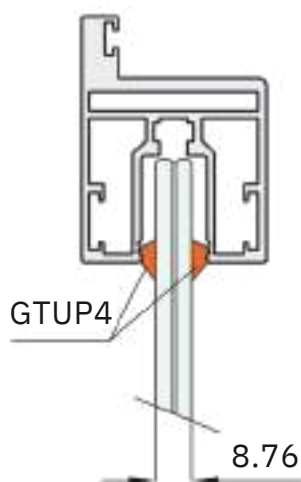
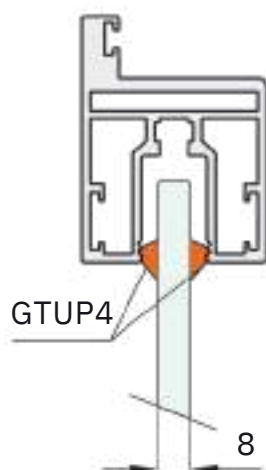
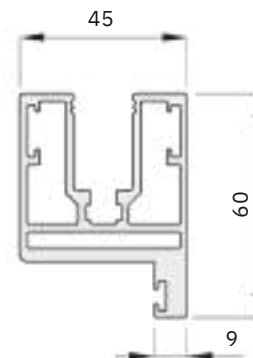



JOINING FRAME FOR PROFILES

Finish: raw stainless steel

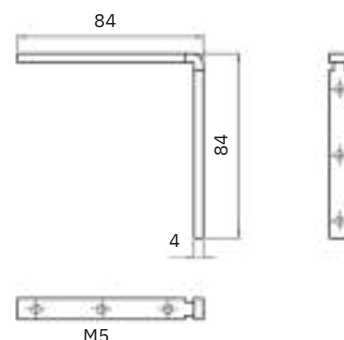

| Art. | Dimensions | Q.ty |
|-------|--------------|-------|
| PD001 | 84x84x9.2 mm | 1 Set |



PROFILE ALIGNMENT FRAME

Material: POM

Finish: black

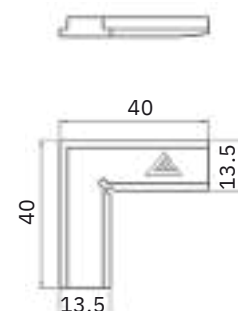

| Art. | Dimensions | Q.ty |
|-------|--------------|-------|
| PD002 | 40x40x5.3 mm | 1 Set |



GASKET PROFILE

Material: PVC

Features: PVC gasket to be inserted into SLEEK and SLEEKdoor profiles.

Finish: transparent, embossed

| Art. | Description | Finish | Q.ty |
|-------|-------------------------------------|-----------|------|
| GTUP2 | Transparent gasket - Thickness 2 mm | Transpare | 1 m |
| GTUP3 | gasket - Thickness 3 mm | nt | 1 m |
| GTUP4 | Transparent gasket - Thickness 4 mm | Transpare | 1 m |
| | | nt | |
| | | Transpare | |
| | | nt | |



GASKET FOR DOOR STOP

Material: PVC (PD12), silicone (PD8A) Features: gasket for stop on a doorjamb. 2 different dimensions available, according to the door glass thickness. Finish: black (PD8A)



| Art. | Glass thickness | Q.ty |
|------|--------------------|-------|
| PD8A | From 8 to 10.76 mm | Per m |



PDMUR66 - WALL MOUNTING KIT

Material: aluminium profile, aluminium template, stainless steel frame

Features: Kit for wall fastening profile SLEEKDOOR66

Important: only SLEEKDOOR66 profiles are suitable

TYPES OF USE:

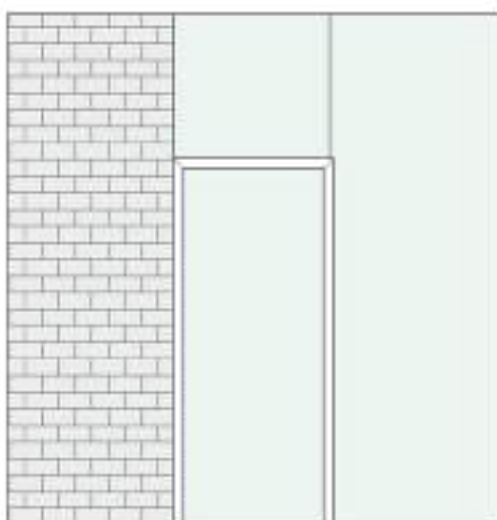

In this case, order 1 kit

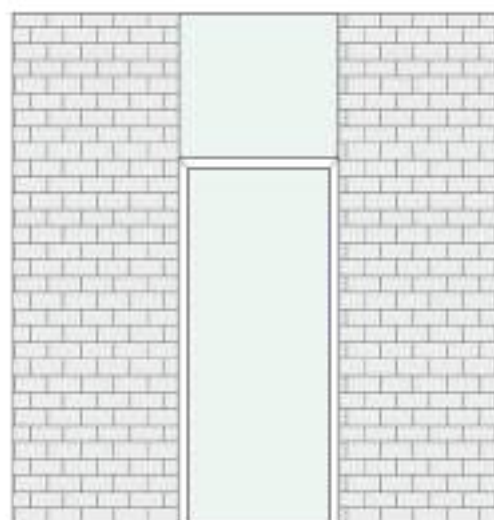

In this case, order 2 kits

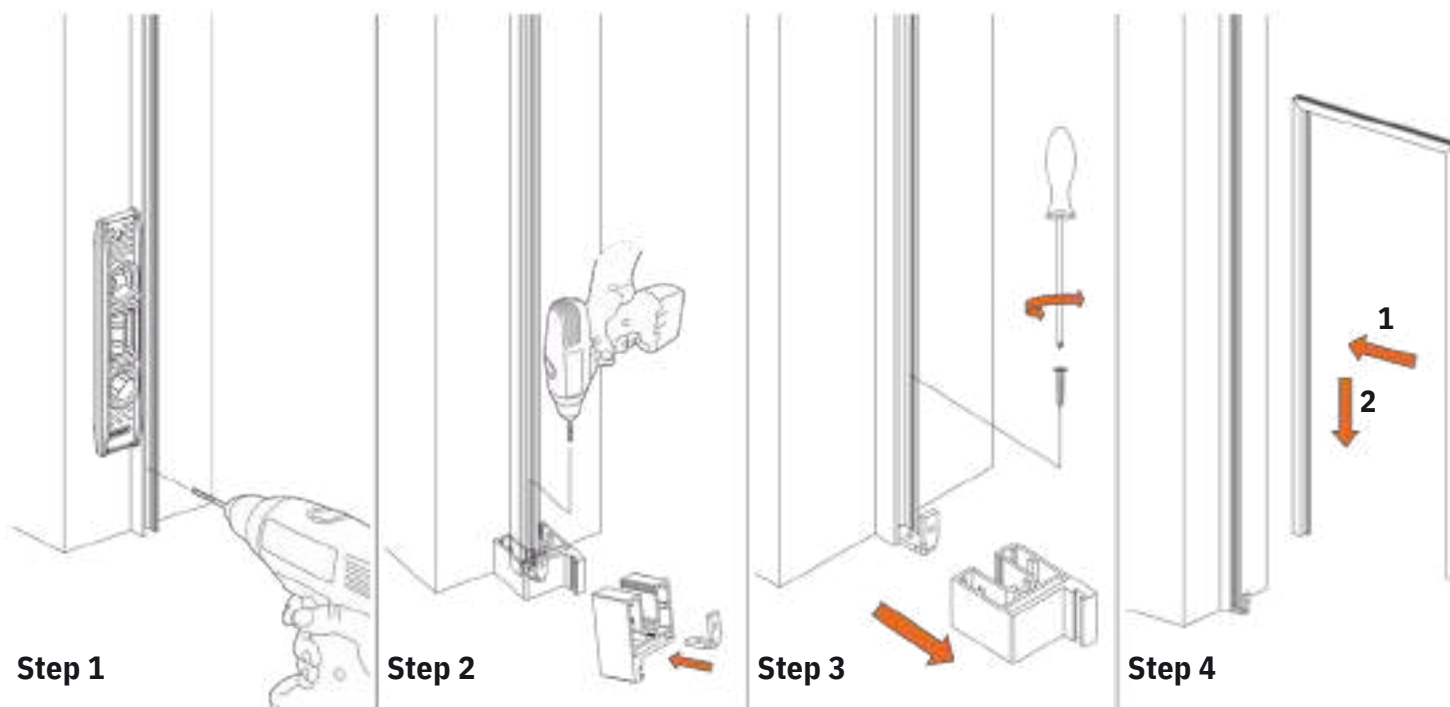





SLEEK DOOR 100 KIT

Material: aluminium

Features: Lock kit Art.APRO1203 single key plus pair of hinges Art.CER4AL.

For glass 8/10 mm. Wall plate included.



Name: Glass Door Lock with Lever handle, curved
Lever handle: Solid in aluminum alloy
Material: Aluminum alloy
Finish: Aluminium Anodized (Silver) - Black matt finish
Glass thickness : 8-10mm
Lock prepared for profile cylinder
Noise-reducing Latch



Name: Glass Door Hinges, curved
Material: Aluminum alloy
Finish: Aluminium Anodized (Silver) - Black matt finish
Glass thickness : 8-10mm
Max door width: 900mm
Max door weight: 50kg/2 hinges, 60kg/3 hinges

SLEEK DOOR 300 KIT

Material: aluminium

Features: Lock kit Art.APRO2203 single key plus pair of hinges Art.CER4ALSQ.

For glass 8/10 mm. Wall plate included.



Name: Glass Door Lock with Lever handle,square

Lever handle: Solid in aluminum alloy

Material: Aluminum alloy

Finish: Aluminium Anodized (Silver) - Black matt finish

Glass thickness : 8-10mm

Lock prepared for profile cylinder

Noise-reducing Latch

Name: Glass Door Hinges,square

Material: Aluminum alloy

Finish: Aluminium Anodized (Silver) - Black matt finish

Glass thickness : 8-10mm

Max door width:900mm

Max door weight: 50kg/2 hinges, 60kg/3 hinges

TOP & BOTTOM HINGES FOR FRAMELESS GLASS DOOR

Material: Aluminum alloy

Finish: Silver/Matt black

Glass thickness : 8-10mm

Max door width:900mm

Max door weight: 50kg/2 hinges

Consisting of 1 floor pivot,1 bottom corner hinge (height adjustable), 1 top pivot,1 top corner hinge.



Step 1: Set the door frame

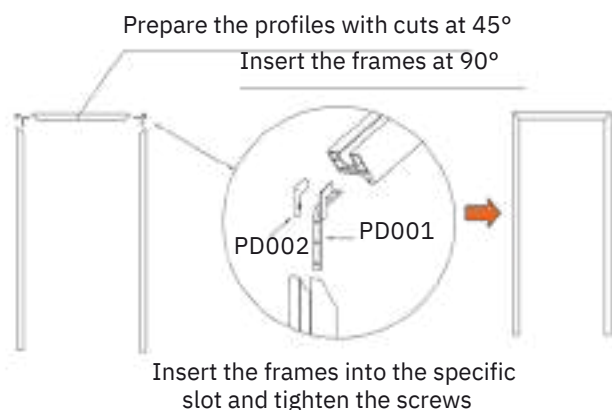

Step 2: fix the SLEEK profile

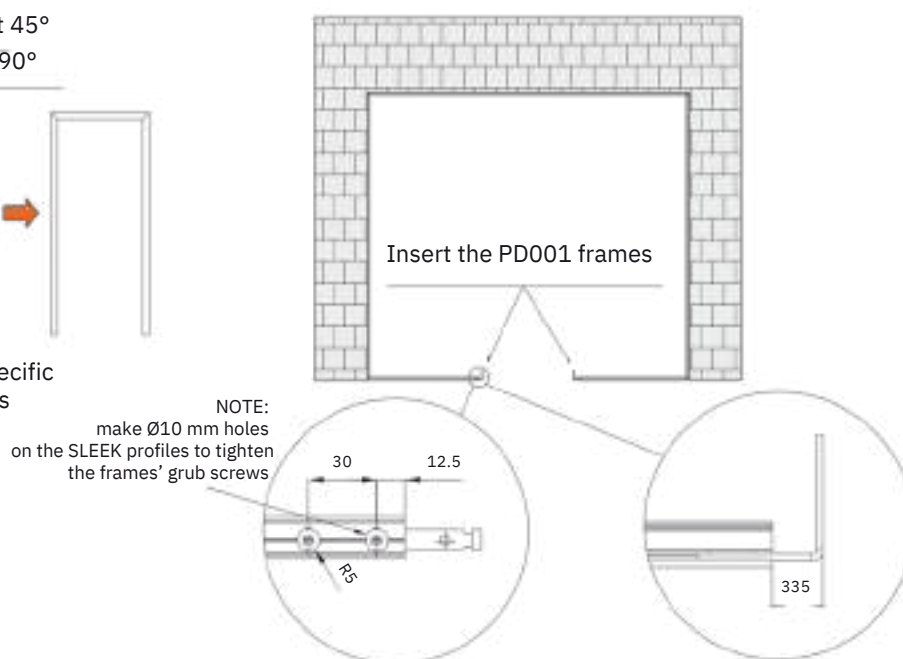

Step 3: Insert the pre-fitted intrados onto the SLEEK

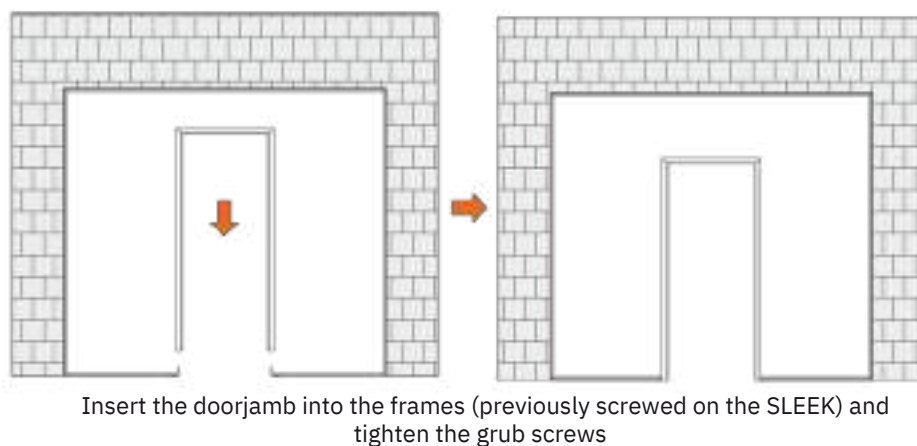

Step 4: Insert the glass

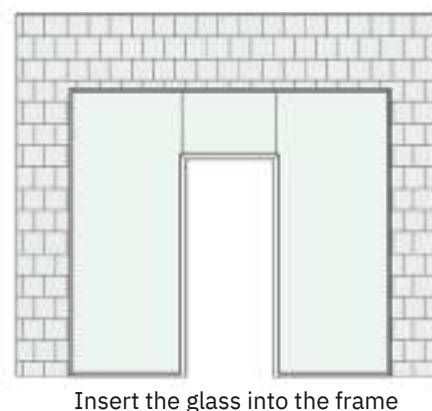

Step 5: Close the profiles SLEEK A, B, C, D, E

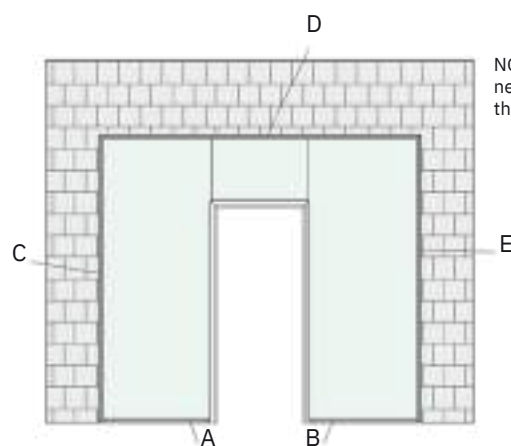

NOTE: For the SLEEK front closing profiles next to the intrados, A and B, the flap must be cut as shown in the figure

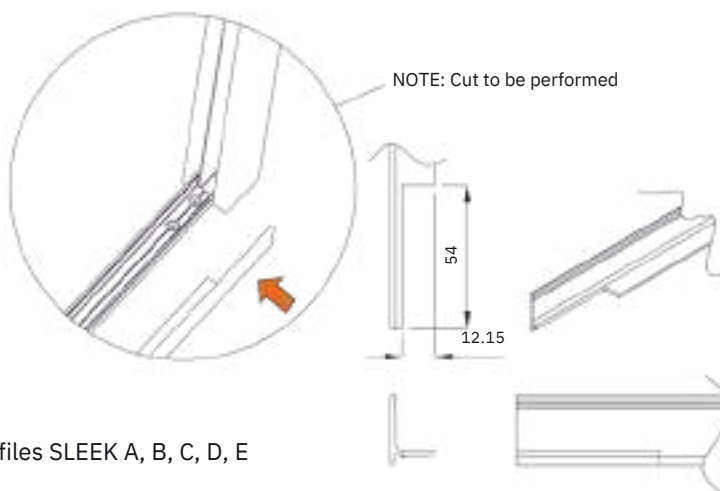

Mount the front closing part of profiles SLEEK A, B, C, D, E

Step 6: Fix the glass

Finish the installation by locking the glass using silicone profiles series GTUP to be inserted along the entire outline of the SLEEK and SLEEKdoor

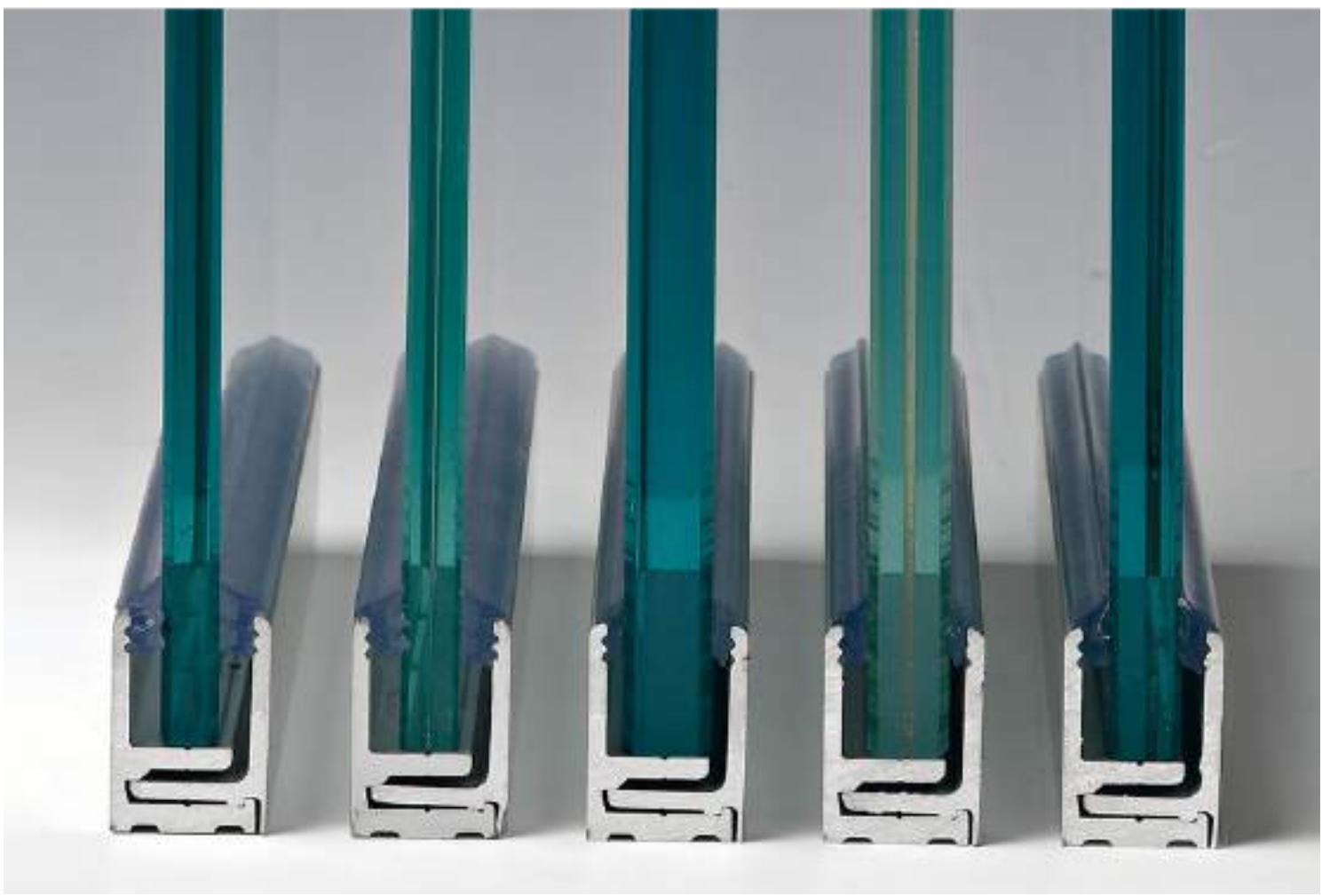
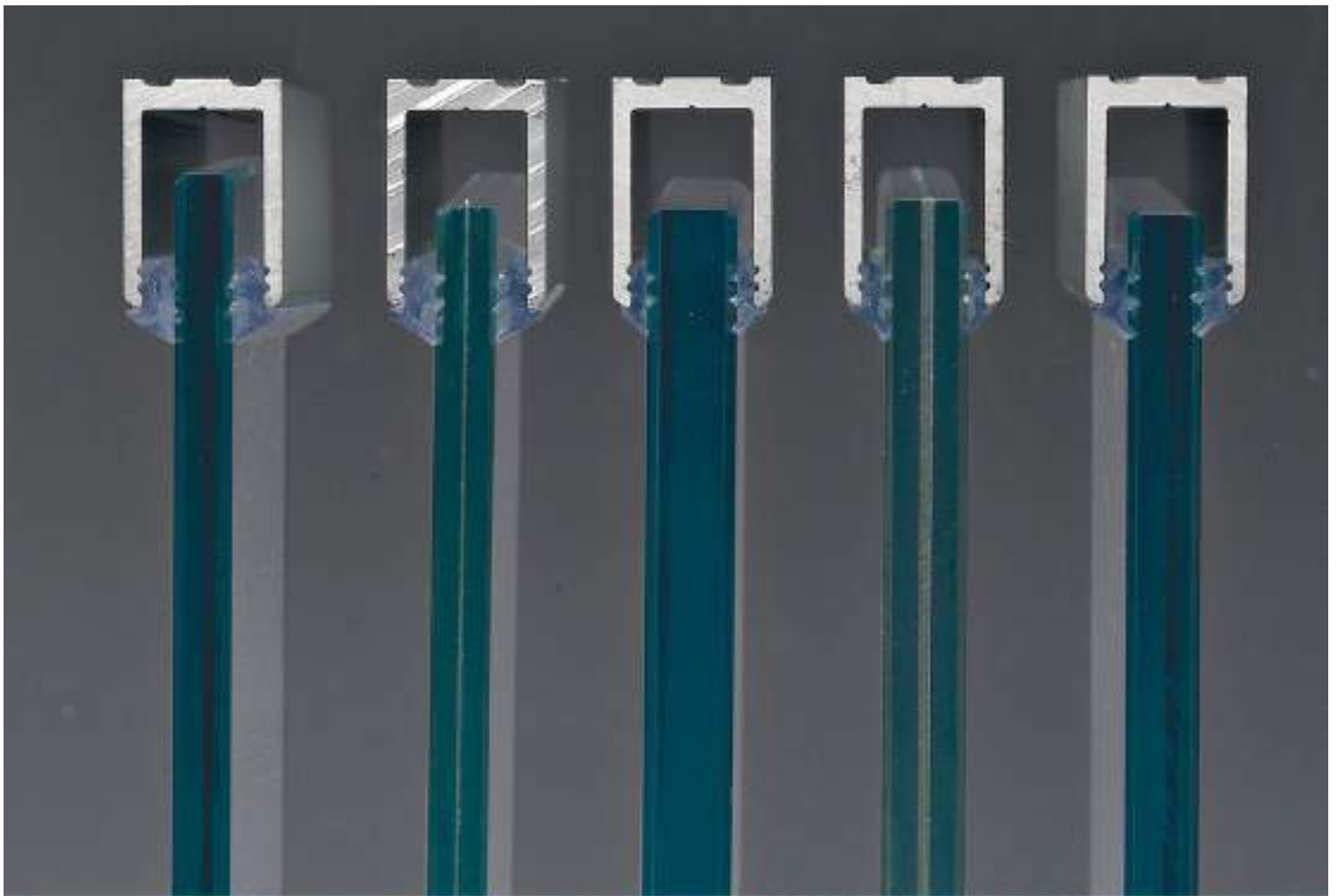



U-SECTION ALUMINIUM PROFILE

Material: extruded aluminium
Features: 3000 mm long aluminium profiles with round edges and internal joint for easier drilling.
Finish: aluminium, anodized, black matt, other finishes on demand



U-section profile caps
SLEEKTPU

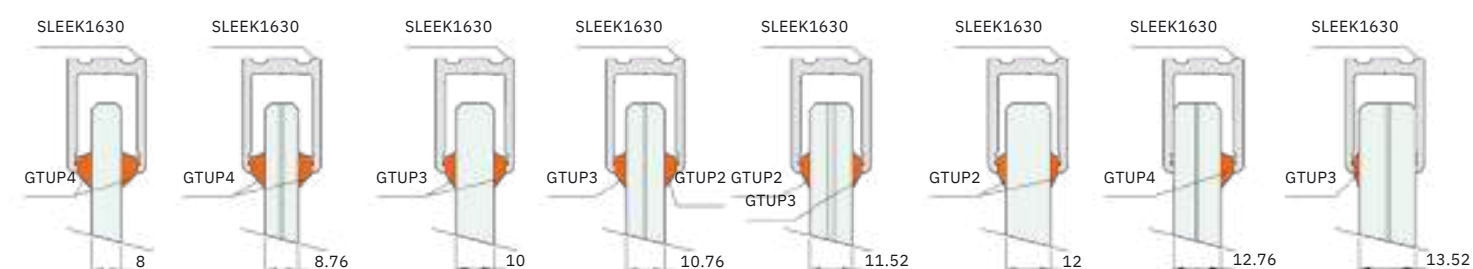
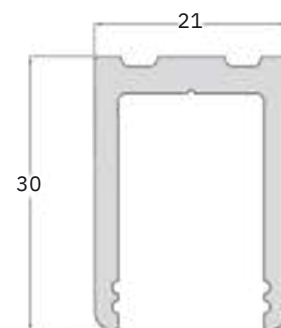

| Art. | Dimensions | Q.ty |
|------------------|-------------------------------------|------|
| SLEEK1630 | 21 x 30 x L 3000 mm | 1 Pc |
| SLEEKTPU | 21 x 30 mm - U-section profile caps | 1 Pc |



CLIP-ON ALUMINIUM PROFILE

Material: extruded aluminium
Features: 3000 mm clip-on aluminium profiles for easy and quick assembly. Finish: anodized, black matt, other finishes on demand

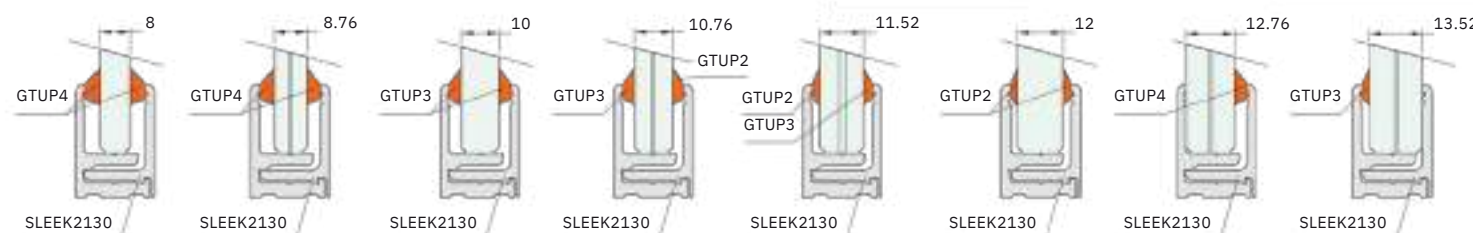
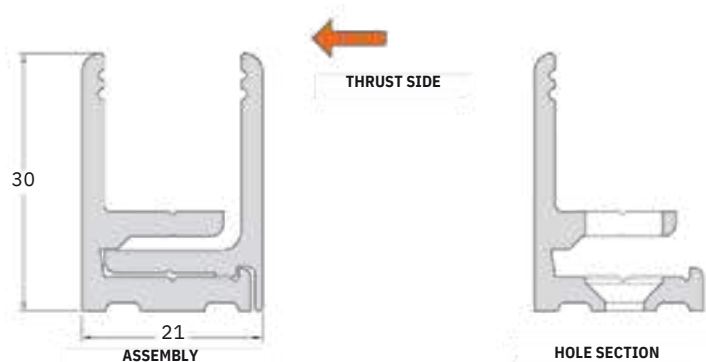

| Art. | Dimensions | Q.ty |
|------------------|---------------------|------|
| SLEEK2130 | 21 x 30 x L 3000 mm | 1 Pc |

SLEEK T CONNECTING PROFILE

Material: extruded aluminium

Features: three or four way aluminium connecting profile. The system is made up by joining the two SLEEK T1 and SLEEK T2 profiles with the SLEEK 2130 or SLEEK 2160 profile.

Finish: aluminium, anodized, black matt, other finishes on demand.

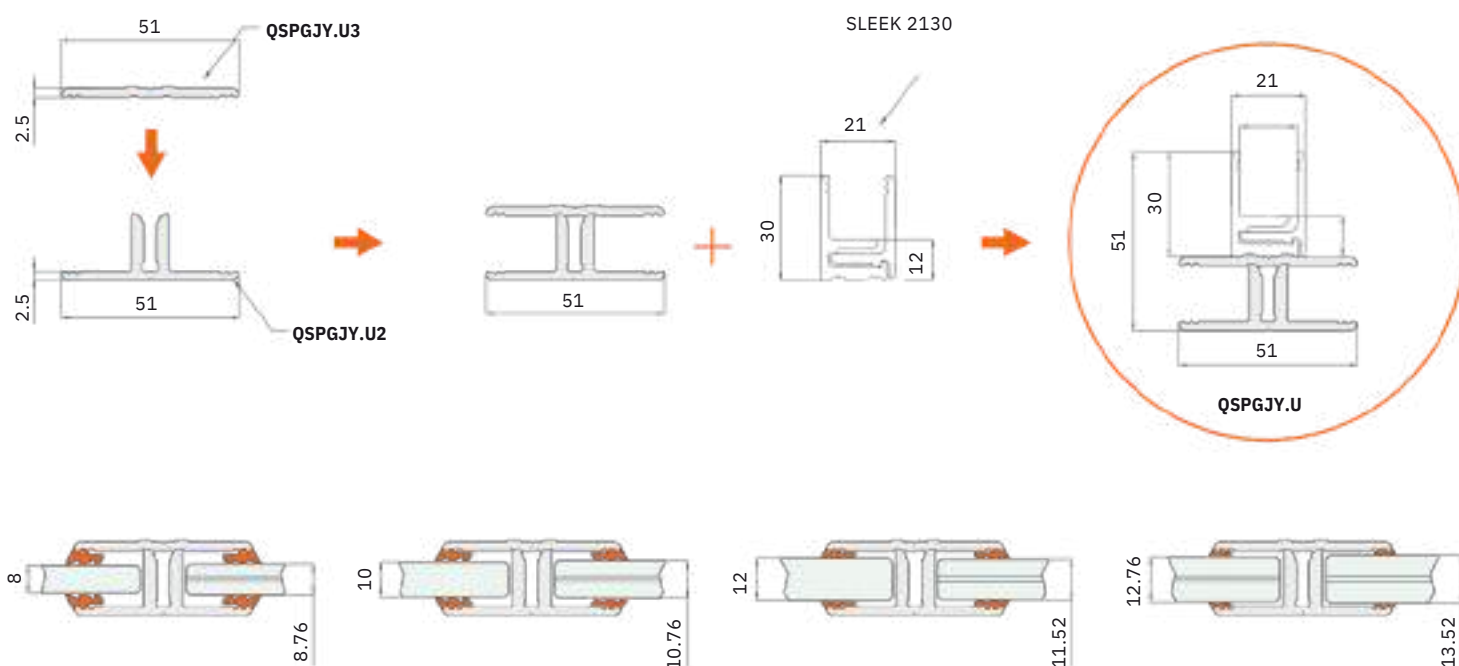

Art.
SLEEK T30

Dimensions
51mm x 51mm x L3000mm

Glass thickness
8/8.76/10/10.76/11.52/12/12.76/13.52 mm

Q.ty
1 kit

ASSEMBLY DIAGRAM (A)



$\text{SLEEK} - h_v$ (glass height) = H (door-opening height) - 30 mm

ASSEMBLY DIAGRAM (B)

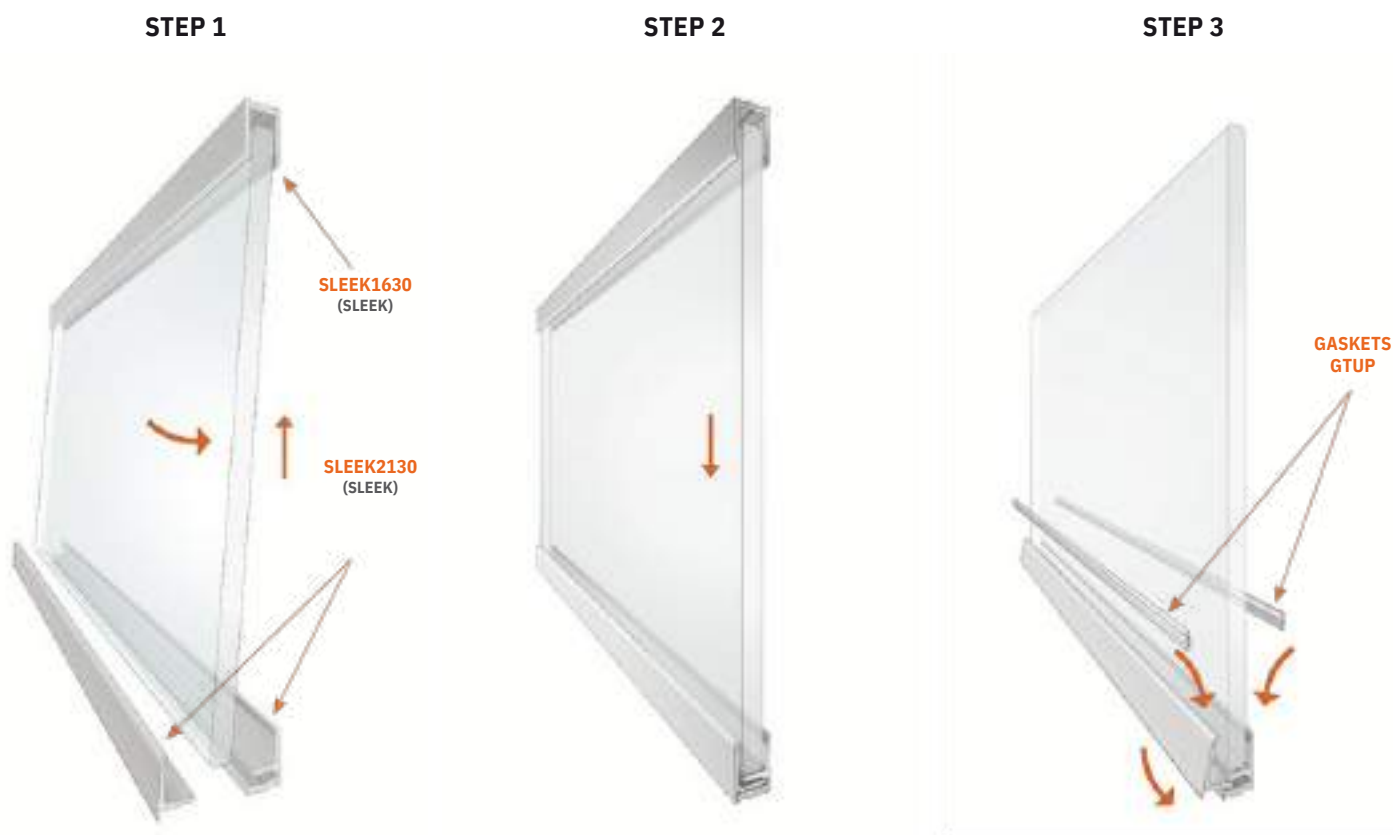

$\text{SLEEK} - h_v$ (glass height) = H (door-opening height) - 25 mm



CLIPPER CLEAR 2-WAY PROFILES WITH NORTON TAPES

Material: polycarbonate

Features: clipper clear profiles with 3000 mm long with adhesives for joining in-line panes.

Profile supplied with adhesive applied on both sides. Colour: transparent

Minimum package

5 Pcs also mixed

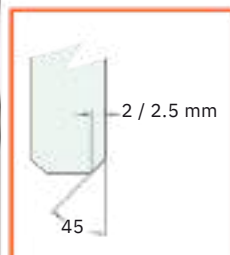

10 mm



5.5+1.52



12 mm

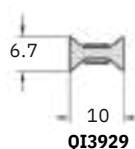

QI3929

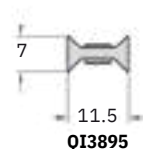

QI3895

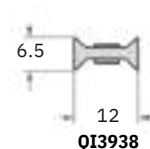

QI3938

| Art. | Dimensions | Applications | Q.ty |
|--------|-------------|-------------------------------------|------|
| PH2818 | 10 x 6.7 mm | For glass thickness 10 mm | 1 Pc |
| PH2784 | 11.5 x 7 mm | For glass thickness 5 + 5 + 1.52 mm | 1 Pc |
| PH2827 | 12 x 6.5 mm | For glass thickness 12 mm | 1 Pc |

CLIPPER CLEAR 90 PROFILES WITH NORTON TAPES

Material: polycarbonate

Features: clipper clear profiles with 3000 mm long with adhesives for joining of glasses at 90°.

Profile supplied with adhesive applied on both sides. Colour: transparent

Minimum package

5 Pcs also mixed

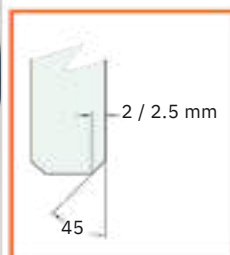

10 mm



5.5+1.52



12 mm

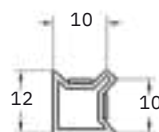

PH2819

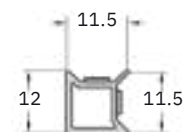

PH2792

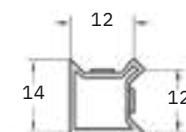

PH2828

| Art. | Dimensions | Applications | Q.ty |
|--------|------------|-------------------------------------|------|
| PH2819 | 12 x 12 mm | For glass thickness 10 mm | 1 Pc |
| PH2792 | 12 x 12 mm | For glass thickness 5 + 5 + 1.52 mm | 1 Pc |
| PH2828 | 14 x 14 mm | For glass thickness 12 mm | 1 Pc |

CLIPPER CLEAR 3-WAY PROFILES WITH NORTON TAPES

Material: polycarbonate

Features: clipper clear profiles with 3000 mm long with adhesives for joining in-line panes and at 90°. Profile

supplied with adhesive applied on both sides. Colour: transparent

Minimum package

5 Pcs also mixed

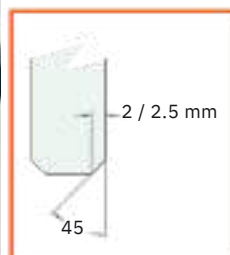

10 mm



5.5+1.52



12 mm

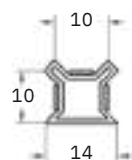

PH2826

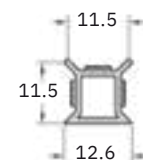

PH2790

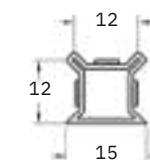

PH2829

| Art. | Dimensions | Applications | Q.ty |
|--------|-------------------|-------------------------------------|------|
| PH2826 | 10 x 14 mm 11.5 x | For glass thickness 10 mm | 1 Pc |
| PH2790 | 12.6 mm 12 x | For glass thickness 5 + 5 + 1.52 mm | 1 Pc |
| PH2829 | 15 mm | For glass thickness 12 mm | 1 Pc |



Authorized partner: Decor Masters
LLP

Phone : +91 8595371483
+91 8851094099

Address- 97/1, Adhchini, Sri
Aurobindo Marg, near Hauz Khas
metro station, New Delhi 110017

Email: info@decor-masters.com